



# ALOE GARDEN ROOM

This 20.8 m<sup>2</sup> garden room offers generous space with a panoramic window, filling the area with natural light, creating a bright, versatile space for a range of activities.



Product Name	ALOE
Category	Garden room
Size	W 6.4x3.9m   H 2.5m
Roof area	25.3 m2
Living space	20.8 m2
Insulation	Insulated A+   SIPS 124mm   SIPS 174mm
Product type	Self Build KIT



## EXCELLENT INSULATION

The insulation capacity is elevated by up to 50% compared to conventional building materials



## PREMIUM MATERIALS

Our kits are comprised of top-tier components and materials, ensuring superior quality and finishes



## SUSTAINABILITY

Our KITS are made from renewable materials and produce less waste than traditional construction methods

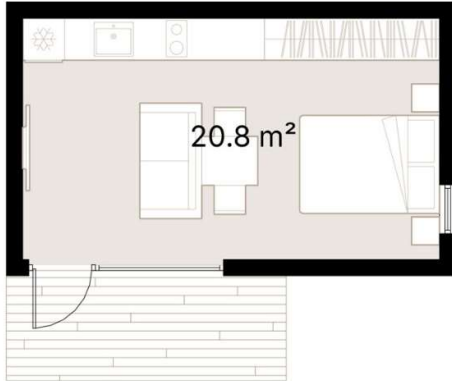

Enjoy generous space in this 20.8 m<sup>2</sup> garden room, which provides ample room for various uses. Its panoramic window floods the space with natural light, creating an inviting atmosphere for a range of activities.

Transform it into a multifunctional space tailored to your needs; whether you require a dedicated home office, a cozy reading nook, an inspiring art studio, or a personal gym, this garden room accommodates it all. Additionally, with its larger size, it can easily serve as an overflow guest bedroom for visiting friends or family.

Whatever your lifestyle, this garden room offers versatility and comfort for your needs. Its expansive layout allows for the inclusion of additional features, such as built-in storage solutions, seating areas, or even an exercise area, ensuring that it meets all of your requirements for a truly personalized outdoor retreat

## SPECIFICATION

Dimensions	W 6.4x3.9m   H 2.5m
Category	Garden room
Roof area	25.3 m <sup>2</sup>
Living space	20.8 m <sup>2</sup>
Exterior Walls	SIPS 124mm, EPS Carbon treated, 0,031 W/mK, OSB3
Roof structure	SIPS 174mm, EPS Carbon treated, 0,031 W/mK, OSB3
Internal walls	-
Windows / doors	PVC Double-glazed, 6-chamber profile, Anthracite grey (both sides)
Roof cover	Elevate's RubberGard™ EPDM, 1.14mm thick, fully adhered system
Exterior trim	Natural Pine/Spruce trim, sanded to a smooth finish Low-maintenance Thermowood Pine/Spruce trim, sanded to a smooth finish (optional) T&G Low-maintenance Iron Sulphate coated Larch timber cladding (optional)
Breathable membrane	DuPont™ Tyvek® Housewrap
Exterior sills	Steel, Anthracite grey
Parapet Flashing	Steel, Anthracite grey
Interior covering	T&G natural Pine/Spruce trim, sanded to a smooth finish Wood fiber board paneling, Pure white / Light grey (optional)
Flooring	Laminate flooring, 8mm, AC5
Skirting	Natural wood, sanded to a smooth finish
Interior sills	Solid wood panel, sanded to a smooth finish
Interior door	-
Foundation (not included)	Any type of foundation can be used: Concrete Pad / Concrete Base / Ground Screw / etc.
Water Supply and Sewerage, Electrical installation, HVAC (not included)	Any type of Water Supply /Sewerage, Electrical installation, HVAC systems must be done ensuring local requirements