



# DAISY GARDEN ROOM

This 16.9 m<sup>2</sup> garden room is ideal for a creative studio, work-from-home office, or entertainment space, offering versatility for work and leisure activities.



Product Name	DAISY
Category	Garden room
Size	W 5.2x4.0m   H 2.5m
Roof area	20.9 m <sup>2</sup>
Living space	16.9 m <sup>2</sup>
Insulation	Insulated A+   SIPS 124mm   SIPS 174mm
Product type	Self Build KIT



## EXCELLENT INSULATION

The insulation capacity is elevated by up to 50% compared to conventional building materials



## PREMIUM MATERIALS

Our kits are comprised of top-tier components and materials, ensuring superior quality and finishes



## SUSTAINABILITY

Our KITS are made from renewable materials and produce less waste than traditional construction methods

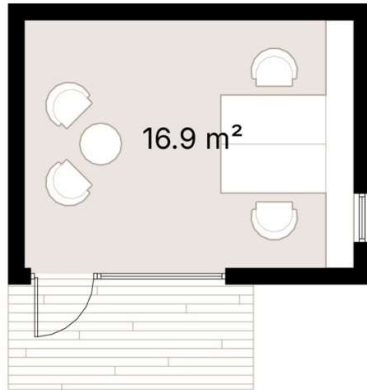

This 16.9 m<sup>2</sup> garden room offers ample space for a variety of activities, making it perfect for creating a spacious creative studio for artistic endeavors.

With its panoramic window, it's also an excellent choice for a comfortable work-from-home office with plenty of room for productivity. Additionally, it can be transformed into an entertainment room for movies, games, or music, providing a versatile space for both work and leisure.

With vast possibilities for customization and enjoyment, this garden room is designed to accommodate your unique needs and preferences. Its generous size allows for the incorporation of additional features, such as a small kitchenette or cozy seating area, or even a personal gym, providing even greater functionality and convenience

## SPECIFICATION

Dimensions	W 5.2x4.0m   H 2.5m
Category	Garden room
Roof area	20.9 m <sup>2</sup>
Living space	16.9 m <sup>2</sup>
Exterior Walls	SIPS 124mm, EPS Carbon treated, 0,031 W/mK, OSB3
Roof structure	SIPS 174mm, EPS Carbon treated, 0,031 W/mK, OSB3
Internal walls	-
Windows / doors	PVC Double-glazed, 6-chamber profile, Anthracite grey (both sides)
Roof cover	Elevate's RubberGard™ EPDM, 1.14mm thick, fully adhered system
Exterior trim	Natural Pine/Spruce trim, sanded to a smooth finish Low-maintenance Thermowood Pine/Spruce trim, sanded to a smooth finish (optional) T&G Low-maintenance Iron Sulphate coated Larch timber cladding (optional)
Breathable membrane	DuPont™ Tyvek® Housewrap
Exterior sills	Steel, Anthracite grey
Parapet Flashing	Steel, Anthracite grey
Interior covering	T&G natural Pine/Spruce trim, sanded to a smooth finish Wood fiber board paneling, Pure white / Light grey (optional)
Flooring	Laminate flooring, 8mm, AC5
Skirting	Natural wood, sanded to a smooth finish
Interior sills	Solid wood panel, sanded to a smooth finish
Interior door	-
Foundation (not included)	Any type of foundation can be used: Concrete Pad / Concrete Base / Ground Screw / etc.
Water Supply and Sewerage, Electrical installation, HVAC (not included)	Any type of Water Supply /Sewerage, Electrical installation, HVAC systems must be done ensuring local requirements