



# IRIS GARDEN ROOM

This charming 7.8m<sup>2</sup> garden room creates a serene escape, ideal for working, unwinding, or hobbies, offering flexible options in a calm, peaceful space.



Product Name	IRIS
Category	Garden room
Size	W 4.2x2.5m   H 2.5m
Roof area	10.6 m <sup>2</sup>
Living space	7.8 m <sup>2</sup>
Insulation	Insulated A+   SIPS 124mm   SIPS 174mm
Product type	Self Build KIT



## EXCELLENT INSULATION

The insulation capacity is elevated by up to 50% compared to conventional building materials



## PREMIUM MATERIALS

Our kits are comprised of top-tier components and materials, ensuring superior quality and finishes



## SUSTAINABILITY

Our KITS are made from renewable materials and produce less waste than traditional construction methods

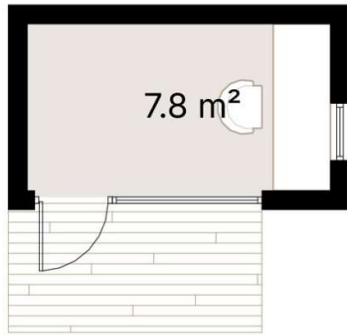

This cozy 7.8m<sup>2</sup> garden room offers a peaceful retreat suitable for various uses. With its panoramic window providing ample natural light, it's perfect for creating a productive workspace away from the distractions of your main house.

Whether you need a quiet spot to work, create, or simply unwind, this garden room provides the perfect sanctuary. It can be transformed into a serene reading nook, an cozy art studio, or even a small meditation space.

Its compact size makes it easy to integrate into any outdoor space, whether nestled among garden greenery or positioned as a standalone feature. Despite its small footprint, the possibilities for customization are endless, ensuring that you can tailor it precisely to your needs and preferences.

## SPECIFICATION

Dimensions	W 4.2x2.5m   H 2.5m
Category	Garden room
Roof area	10.6 m <sup>2</sup>
Living space	7.8 m <sup>2</sup>
Exterior Walls	SIPS 124mm, EPS Carbon treated, 0,031 W/mK, OSB3
Roof structure	SIPS 174mm, EPS Carbon treated, 0,031 W/mK, OSB3
Internal walls	-
Windows / doors	PVC Double-glazed, 6-chamber profile, Anthracite grey (both sides)
Roof cover	Elevate's RubberGard™ EPDM, 1.14mm thick, fully adhered system
Exterior trim	Natural Pine/Spruce trim, sanded to a smooth finish Low-maintenance Thermowood Pine/Spruce trim, sanded to a smooth finish (optional) T&G Low-maintenance Iron Sulphate coated Larch timber cladding (optional)
Breathable membrane	DuPont™ Tyvek® Housewrap
Exterior sills	Steel, Anthracite grey
Parapet Flashing	Steel, Anthracite grey
Interior covering	T&G natural Pine/Spruce trim, sanded to a smooth finish Wood fiber board paneling, Pure white / Light grey (optional)
Flooring	Laminate flooring, 8mm, AC5
Skirting	Natural wood, sanded to a smooth finish
Interior sills	Solid wood panel, sanded to a smooth finish
Interior door	-
Foundation (not included)	Any type of foundation can be used: Concrete Pad / Concrete Base / Ground Screw / etc.
Water Supply and Sewerage, Electrical installation, HVAC (not included)	Any type of Water Supply /Sewerage, Electrical installation, HVAC systems must be done ensuring local requirements